



Specifications:

Item		Specification	TYPICAL	Q.C LIMIT	Remark
Frequency Range	B-TER		47 ~ 694 MHz		
	C-Backfeed		470 ~ 862 MHz		
	A-SAT		950 ~ 2150 MHz		
Inputs		A SAT/TER / B TER / C B-Feed			F-Type Female Connector
Outputs		8 Taps			
Insertion Gain	Terr.		0 dB	≥ -2 dB	
	SAT		0 dB	≥ -2 dB	
	UHF		0 dB	≥ -2 dB	
Isolation	SAT to Terr.		25 dB	≥ 23 dB	950@862
	B(SAT+TER)-SAT		27 dB	≥25 dB	694@721
	TER-SAT		27 dB	≥25 dB	694@721
			39 dB	≥37 dB	694@862
	OUT-OUT	UHF/Terr.	22 dB	≥ 20 dB	47 ~ 862 MHz
SAT		25 dB	≥ 23 dB	950 ~ 2150 MHz	
Return Loss	SAT/Terr.	Input	10 dB	≥ 8 dB	
		Output	8 dB	≥ 6 dB	
	UHF	Input	10 dB	≥ 8 dB	
		Output	8 dB	≥ 6 dB	
Power from DC_IN or Outputs		18VDC			
DIP Switch for Terrestrial Signal Source		A/B			
DIP Switch for 14V to "B-TER"		0VDC(Default) / 14VDC			
LNB Power Capability		500mA Max.			
Power Consumption without LNB		250mA Max.			
Supplied	External Power Supply	* Option * 1A Max. @ 18VDC		10MM-PSM18F	

For more information call

NZ TOLL FREE: 0800 - AERIAL

or visit our website for our full product catalogue: www.matchmaster.co.nz



For the correct antenna scan the QR code with your Smart Device and visit the most advanced Antenna selection software in New Zealand, what else would expect from Matchmaster.

Input Options

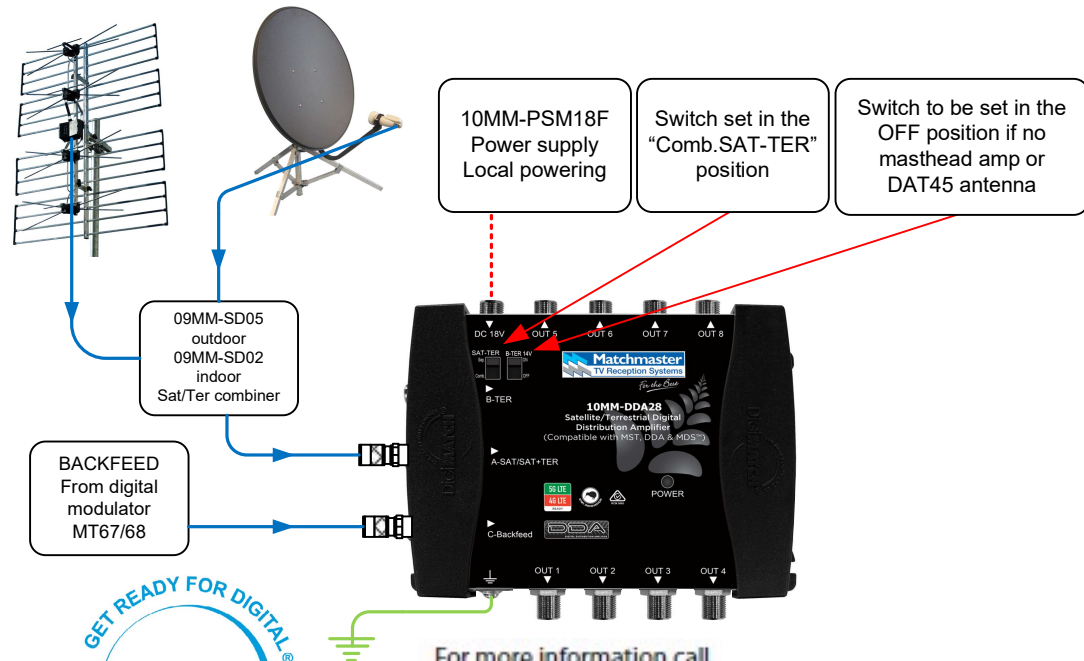
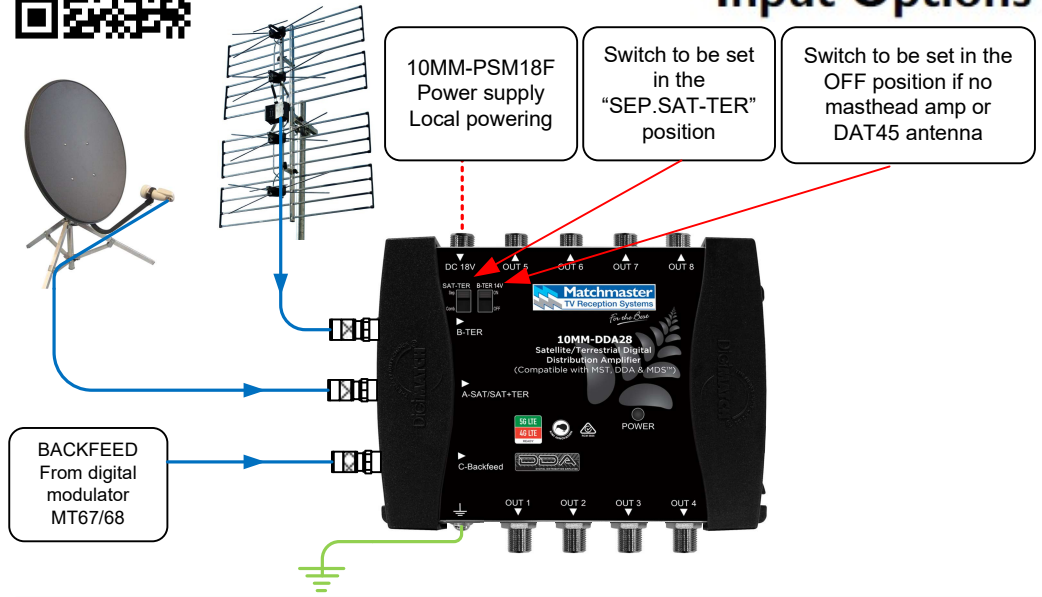

GET READY FOR DIGITAL®
Digital Friendly Device®

For more information call

NZ TOLL FREE: 0800 - AERIAL

or visit our website for our full product catalogue: www.matchmaster.co.nz

Commercial use

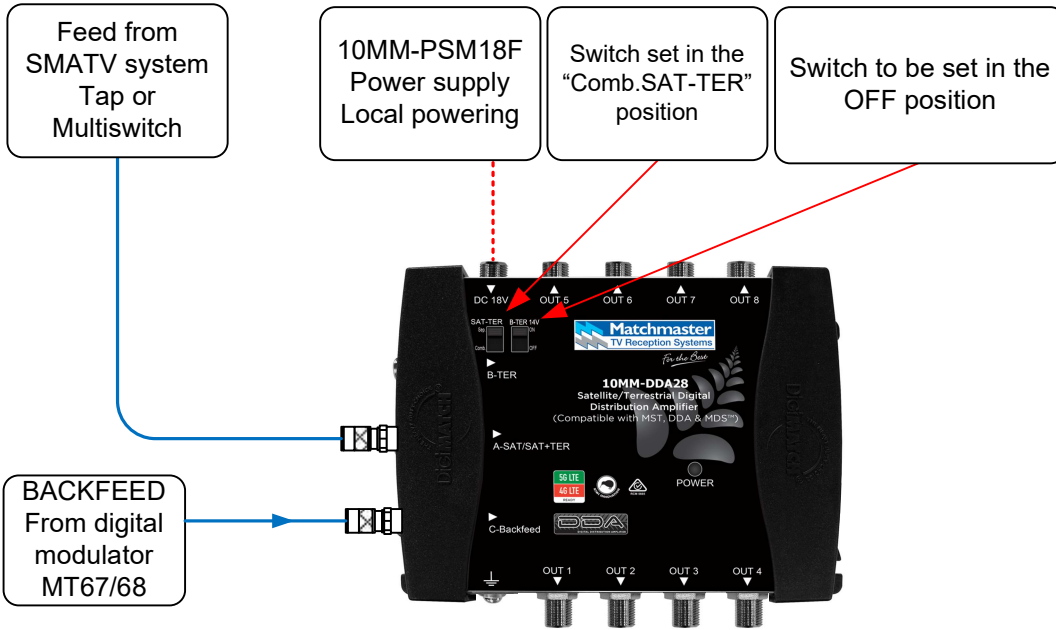

Fault finding

Power light flashes, this means there is a short on the input, test cables and connections also if no masthead amp or DAT45 used switch off TER-14V.

Pixilated picture, this can be poor quality signal from antenna. Test and replace. Too much signal from antenna, test and reduce level.

LTE/4G/5G interference, test and fit a filter DTF01 or DTF02. Sometimes more than one filter maybe required.

For more information call

NZ TOLL FREE: 0800 - AERIAL

or visit our website for our full product catalogue: www.matchmaster.co.nz



For the correct antenna scan the QR code with your Smart Device and visit the most advanced Antenna selection software in New Zealand, what else would expect from Matchmaster.

Power supply

To "local" power the DDA28 (do not plug the power pack into power at this stage) unscrew the "F" connector from the "power injector" and screw the "F" connector on to the "DC-18V" input on the top of the DDA28, plug in the power pack and the green light will illuminate.

The DDA28 can be remote powered from any of the 8 outlets connected to the DDA28 with the use of the power injector as below

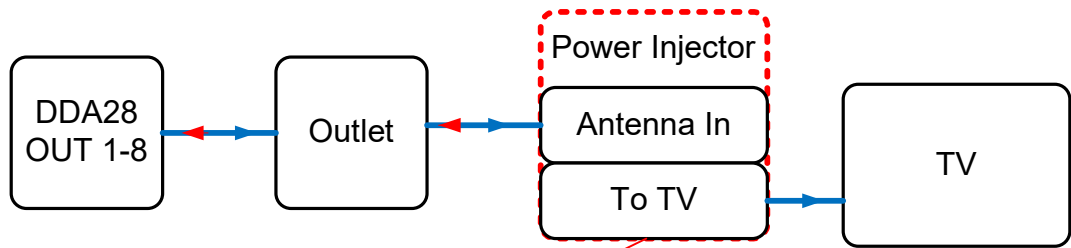

For more information call

NZ TOLL FREE: 0800 - AERIAL

or visit our website for our full product catalogue: www.matchmaster.co.nz